

Paddy Pallin

34TH PADDY PALLIN ROGAINE

15th June 1997

CROWN COPYRIGHT - REPRODUCED FROM CMA 1:25000 MAP OF BARGO. PERMISSION OF THE LAND INFORMATION CENTRE, NSW DEPARTMENT OF LANDS

SCALE 1:25 000



CONTOUR INTERVAL 10 METRES

ELEVATIONS:
 CONTROL: Geodetic Survey of New South Wales based on the Australian Geodetic Datum, Australian Map Grid (UTM) in 8° zones.
 GND: Grid lines are shown at intervals of 1000 metres from False Origin, Zone 55.
PRODUCTION:
 Integrated Survey Grid information shown along border in grey. Zone 501
 Aerial Mapping Authority of New South Wales
 Bureau of Meteorology, Department of Science
METROLOGICAL DATA:
 Contours in National Mapping Council standards.
 Although all care is taken in the preparation of this map, the Central Mapping Authority of New South Wales accepts no responsibility for any misprints, errors, omissions or inaccuracies.
ROADS:
 Depiction of roads and tracks does not necessarily indicate a public right of way. Unsettled roads may be impassable after rain. Crossed roads are indicated by grey lines. For necessary details, refer to the Geographical Names Act, 1986, as approved names.
INDICATOR:
 This map contains the Bargo and Winton Mine Subdivision Districts. For further particulars refer to the Department of Mineral Resources, Sydney.
CAUTION:
 Access to Metropolitan Catchment Area is restricted. For particulars contact the Metropolitan Water Sewerage and Drainage Board.

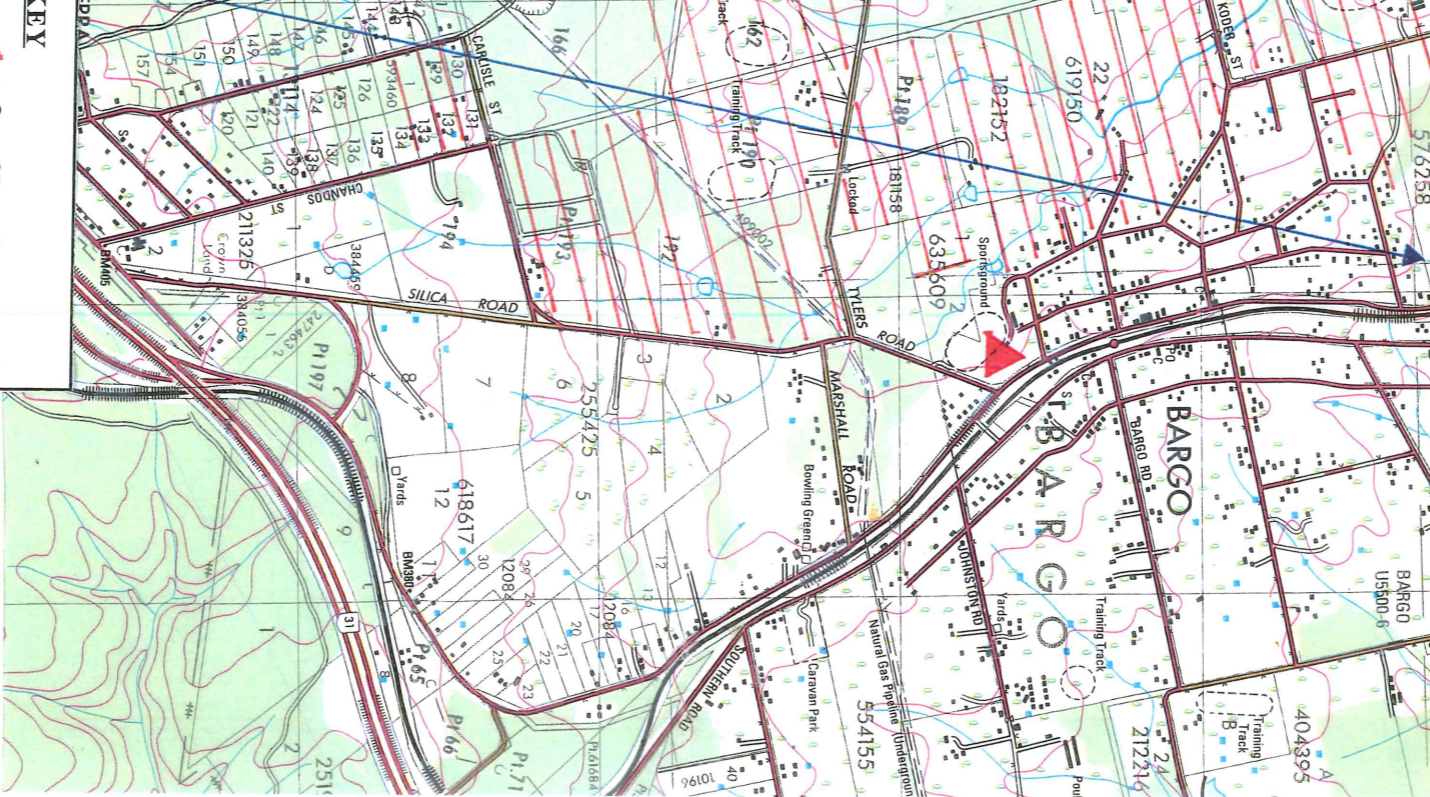

KEY

- Out of Bounds
- Cliff (impassable)
- Hash House
- Control
- Water Drop
- Track (vehicular)
- Track (indistinct/path)

Other symbols and descriptions:

- Eilat: Mud
- Dense timber: Medium timber
- Scattered timber: Forest: Contours or pine
- Orchard, plantation or vineyard: Windbreak
- Mangrove: Scrub
- Perennial watercourse with rapids: Rocks
- Intermittent watercourse with falls
- Well or bore: Irrigation canal and drains
- Large dam or weir: Rapids
- Dam, weirhole or ground tank: Water tank: Spring
- Quarry: Parish boundary
- State boundary: Aboriginal Site (public access)
- State Forest: National Forest boundary
- State Recreation Area: National Park boundary
- Deposited Plan and Lot number: 554529
- Cadastral road: Portion and number
- Mine Subdivision Area: Catchment Area boundary
- Built-up area
- Road sealed surface two or more lanes
- Road sealed surface one lane
- Road loose surface two or more lanes
- Road loose surface one lane: Embankment: Cutting
- Road vehicle: Gate: Stock grid: Foot track
- Route markers: National State: Freeway
- Bridge: Current: Causeway: Kilometer post
- Railway multiple track: Station: Tunnel
- Railway single track: Stop: 1000
- Light railway or tramway
- Power transmission line
- Telephone line: Underground
- Lane or dike: Quarry or gravel pit
- Building: School: Post Office: Police Station: Church
- Windpump: Mine: Heritage Feature: Telephone Exchange
- Geodetic Station (with height): Landmark: Other
- Horizontal control point (with height): Landmark: Other
- Bench mark (with height): Spot height approximate
- Sand: Sand dunes: Sand ridges
- Contours: Approximate contours
- Depression contours: Auxiliary contours
- Landslide: Rocky slope
- Cliff (with relative height): Rocky pinnacle
- Fenced bank: Escarpment: Contour bank
- Steep slope